

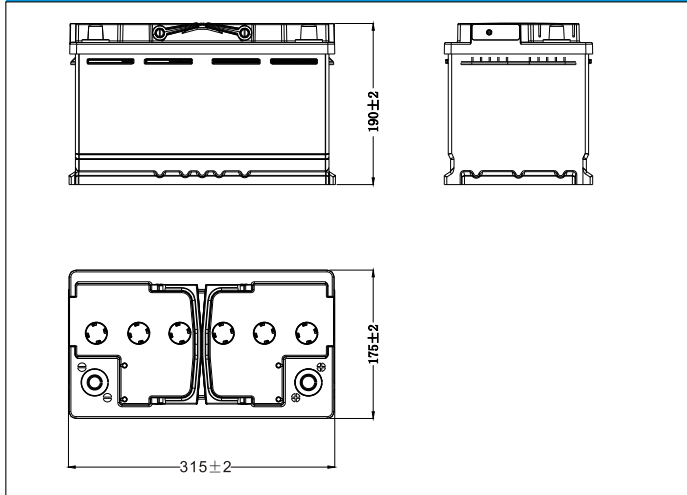

## XR-1600 (AGM-L4, 12V 80Ah)



### Dimensions (mm)



### Physical Specification (mm)

|                        |                             |                                    |
|------------------------|-----------------------------|------------------------------------|
| Nominal Voltage        |                             | 12V                                |
| Nominal Capacity(20HR) |                             | 80Ah                               |
| Dimension              | Length                      | 315±2mm(13.90inches)               |
|                        | Width                       | 175±2mm(6.89inches)                |
|                        | Container Height            | 190±2mm(7.48inches)                |
|                        | Total Height(with Terminal) | 190±2mm(7.48inches)                |
| Weight                 |                             | Approx 24.0g(52.9lbs)              |
| Acid                   |                             | 1.30±0.015g/cm <sup>3</sup> (25°C) |
| Standard Terminal      |                             | T2                                 |
| Cell layout            |                             | B                                  |
| Hold-Down              |                             | B3/B4                              |
| Cell plate qty         |                             | /                                  |
| Case                   |                             | Black-PP Material                  |
| Cover                  |                             | Black-PP Material                  |
| Handle                 |                             | Black-PP Material                  |

### Electrical Specification

|   |                    |        |
|---|--------------------|--------|
| Rated Capacity                            | 20 hour rate(4.0A) | 80Ah   |
| Reserve Capacity                          |                    | 140min |
| Cold Cranking Performance Amps@0°F(-18°C) |                    | 800A   |

### Standard Terminal (mm)

| Terminal Type | D                                 |                                   |
|---------------|-----------------------------------|-----------------------------------|
|               | Positive                          | Negative                          |
| T2            | 19.5 <sup>0</sup> <sub>-0.3</sub> | 17.9 <sup>0</sup> <sub>-0.3</sub> |

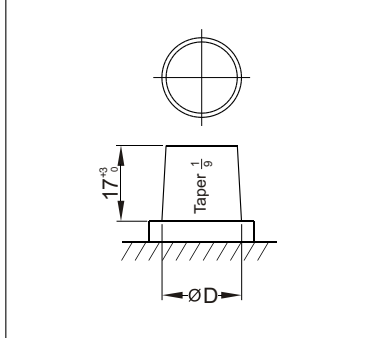

### Cell Layout

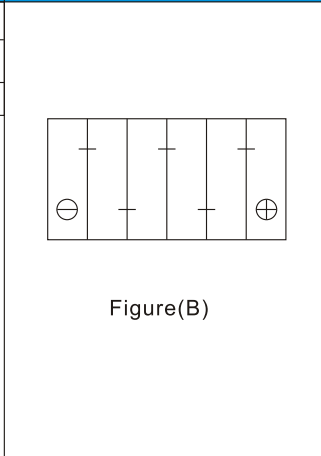

### Discharge Characteristics(25°C,70°F)

